

| Seat Post SI2-14 | |
|------------------|----------|
| black/white | A1038551 |
| black/black | A1038552 |

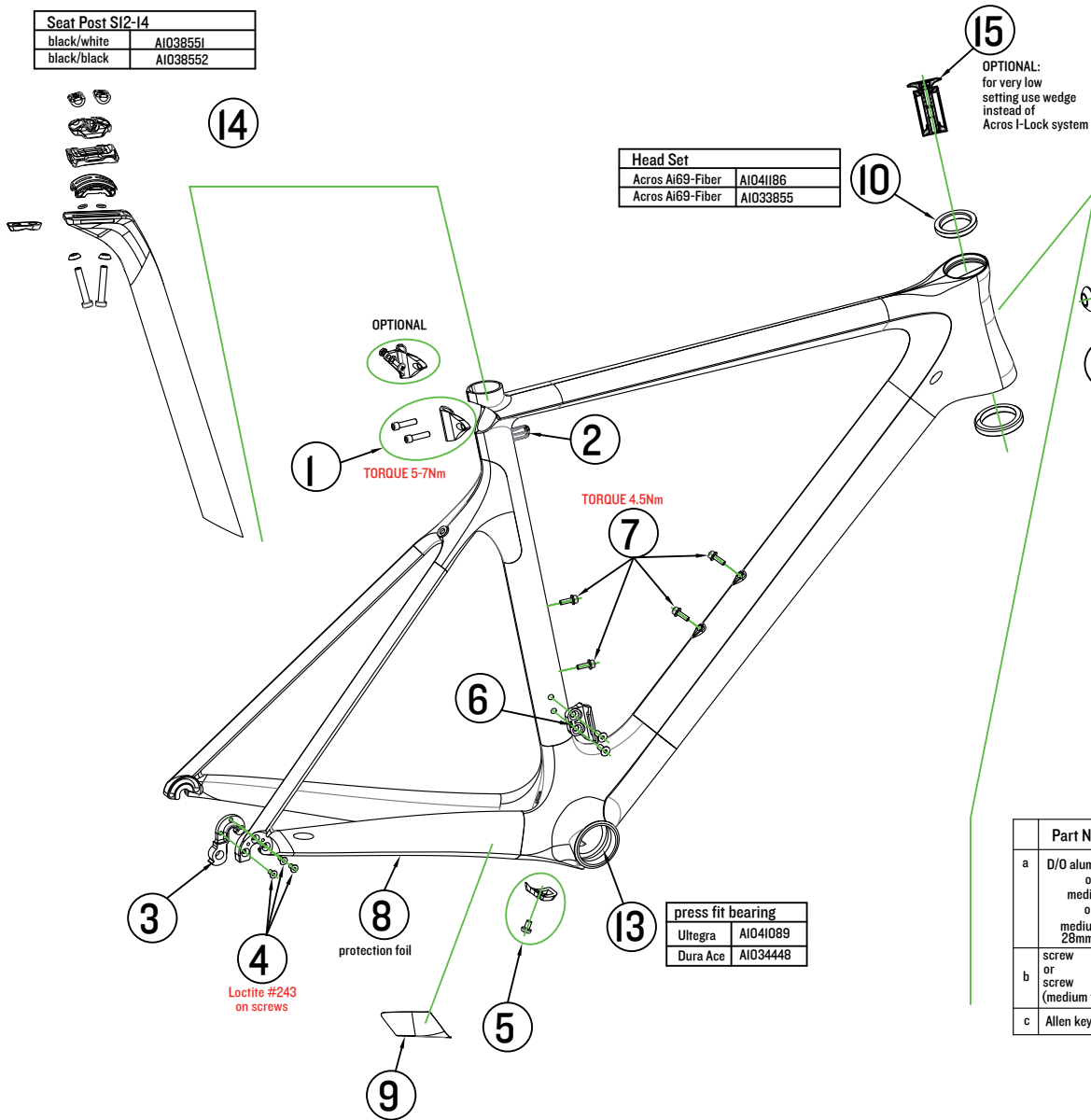

| | Part Name | Description | Material | Qty. | Canyon# |
|---|---|-------------------------------------|------------|------|----------------------------------|
| a | D/O alumi insert or medium or medium for 28mm tyre | E87-II E88-II | AL-6061-T6 | 1Set | A1023432 A1023500 A1023501 |
| b | screw or screw (medium for 28mm tyre) | M3x6 TX10 A2 or M3x10 TX10 A2 | stainless | 2PCS | A1023310 or A1028793 |
| c | Allen key | TX10 | stainless | IPC | A1023431 |

| | Canyon# | Part Name | Qty. |
|----------|-------------|-----------------------------------|--------------------|
| 1 | A1023428 | seat clamp | IPC |
| | | incl. screws | 2PCS |
| | OPTIONAL | OPTIONAL | |
| A1024041 | E68-II | seat clamp with number holder | IPC |
| | | incl. 3 screws and nut | 2PCS IPC IPC |
| | | | |
| 2 | A1022937 | plastic clip-in-cable-holder | E56-12 IPC |
| 3 | A1013398 | RD-Hanger #18 | IPC |
| 4 | | incl. screws | 3PCS |
| | | or for SRAM! (not Red 2013) | |
| | A1027537 | RD-Hanger #23 | 1SET |
| 5 | A1023427 | BB Cable Guide | IPC |
| | | incl. screw | IPC |
| 6 | A1023429 | FD-Hanger | IPC |
| | | incl. screws | 2PCS |
| 7 | A1022843 | water bottle bolt incl. washer | 4PCS |
| 8 | A1037680 | protection foil | IPC |
| 9 | A1024642 | chain suck plate | E83-II IPC |
| 10 | see drawing | Acros Ai-69 | 1SET |
| 11 | see drawing | Aerod Fork CF | F13-14 1SET |
| 12 | A1010304 | front brake bolt | E49-10 IPC |
| 13 | see drawing | B/B bearing | IPC |
| 14 | see drawing | seat post | SI2-14 1SET |
| 15 | A1024066 | wedge for F13-13 | E82-II 1SET |

AEROAD CF | RI6-14

CANYON

REVISION 00 | 25.03.2014